



957 - 969



975 - 987

& 957 - 969
975 - 987
S. BASCOM AVE
SAN JOSE, CA 95128

MULTIPLE RETAIL SPACES FOR LEASE • 560 - 800 SF AVAILABLE

PRIME COMMERCIAL
INCORPORATED

AGENT CONTACT:
LIC. 02180211 **BRENNAN J. MONRO**
bmonro@primecommercialinc.com
(408) 560-6100

01 Property Info

957 - 969

975 - 987

S. BASCOM AVE
SAN JOSE, CA 95128

Overview:

ADDRESS: 957-969 & 975-987 South Bascom Avenue
San Jose, CA 95128

TYPE: Retail

PRICE: See Availability

SIZE: 560 - 800 SF

Highlights:

- In-Line Retail Units Available at 2 Adjacent Buildings
- Highly Visible along South Bascom Avenue
- Minutes Away from Westfield Valley Fair, Santana Row, Valley Medical Health Center, and San Jose City College
- Close Proximity to Highways I-280, I-880, CA Route 17

Demographics:

BY DISTANCE	1 MILE	3 MILE	5 MILE
Avg Household Income	\$165,106	\$192,123	\$197,527
Total Population	30,816	253,639	613,832
Daytime Population	33,302	272,240	662,456

Traffic Counts: (Cars Per Day)

South Bascom Ave

47,000 ADT

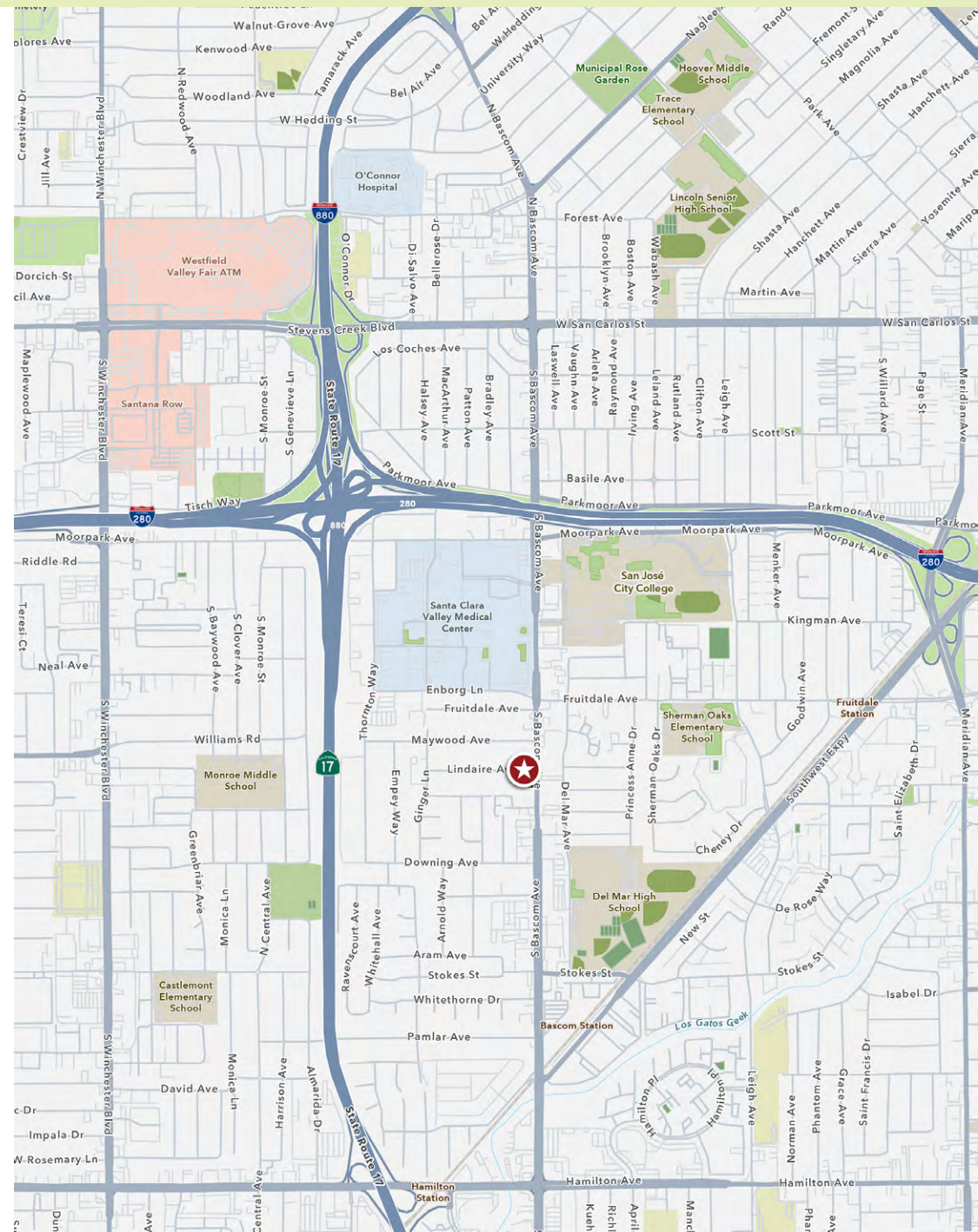

Prime Commercial, Incorporated © 2024 - Prime Commercial, Inc. has obtained the information contained herein from sources we deem reliable. However, we have not verified its accuracy and make no guarantee, warranty or representation about it. It is subject to errors, modification, omission, change of price and/or terms, prior lease sale or financing, or withdraw without notice. It may include projections, opinions, or assumptions or estimated for example only, and they may represent current or future performance of the property. You and your tax and legal advisors should conduct your own of the property and transaction. The information provided in this brochure are estimates only, not representations, and are not intended to be relied upon for any purpose. All demographic information contained in this brochure is obtained from esri.

02 Availability

957 - 969 S. BASCOM AVE
975 - 987 SAN JOSE, CA 95128

969 S. Bascom Ave — 800 SF

\$3,400 / Month All - In (includes NNN)

- Great Endcap Unit
- Perfect for Café/Deli
- Existing ADA Restroom



981 S. Bascom Ave — 800 SF

\$3,200 / Month All - In (includes NNN)

- Former leasing/management office
- Existing Restroom



985 S. Bascom Ave — 560 SF

\$2,690 / Month All - In (includes NNN)

- Former Tax Office
- Built Out for 2 Separate Offices
- Existing Restroom



03 Site Plan (957 - 969 S. Bascom)

957 - 969 S. BASCOM AVE
975 - 987 SAN JOSE, CA 95128

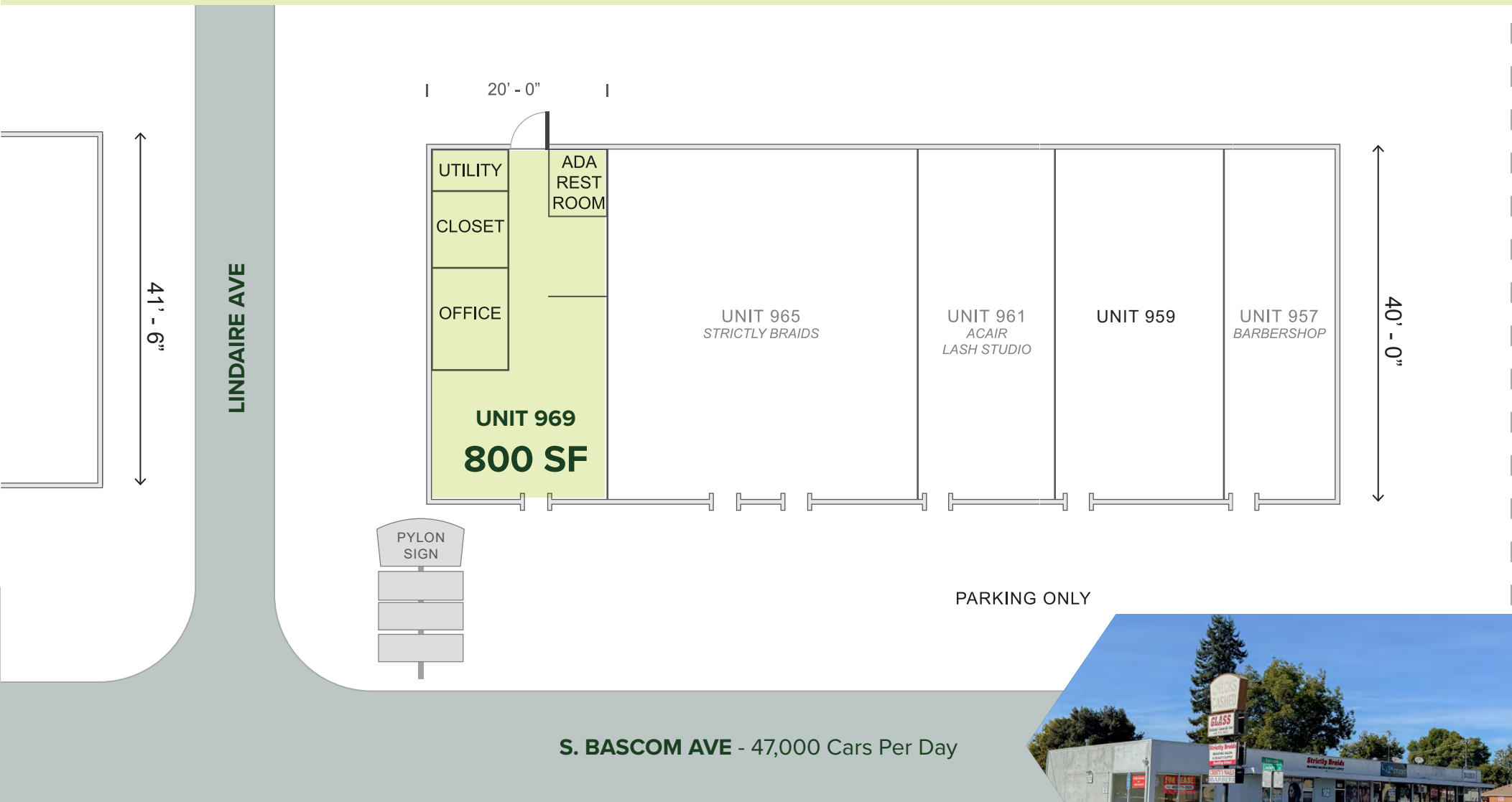

*Not to Scale



04 Site Plan (975 - 987 S. Bascom)

957 - 969 S. BASCOM AVE
975 - 987 SAN JOSE, CA 95128

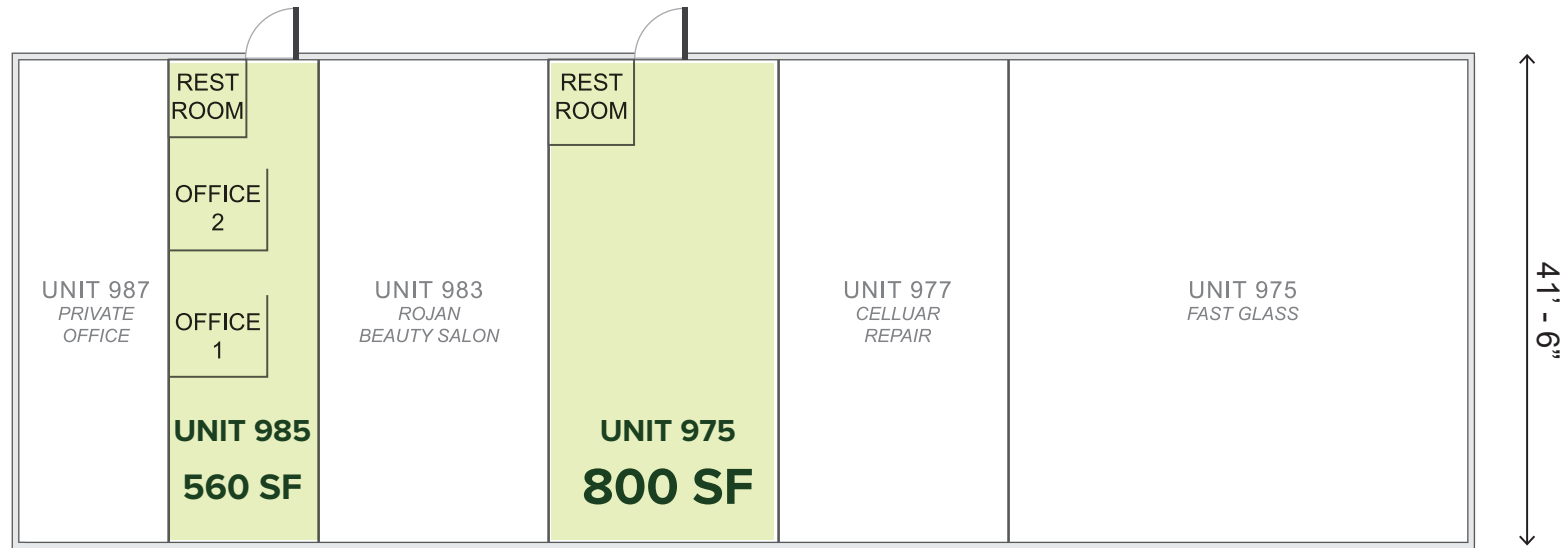

PARKING ONLY

LINDAIRE AVE

S. BASCOM AVE - 47,000 Cars Per Day

*Not to Scale



05 Market Aerial

957 - 969

S. BASCOM AVE

975 - 987

SAN JOSE, CA 95128

