

**FOR SALE**

**14288 Capri Drive / Winchester Boulevard**

**Los Gatos, California**

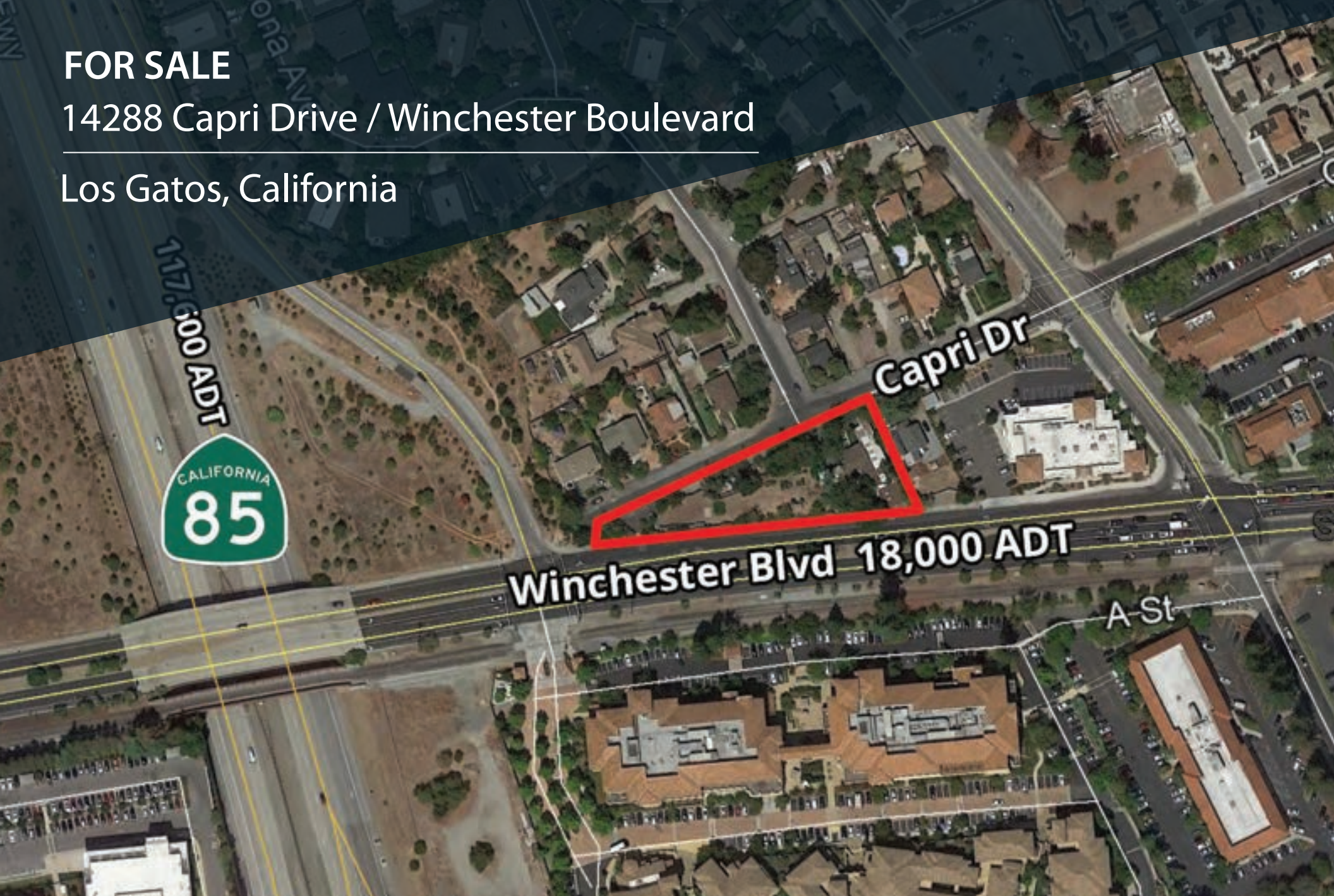

**PRIME COMMERCIAL**  
INCORPORATED

1543 Lafayette Street, Suite C  
Santa Clara, 95050  
Office 408.879.4000  
[www.primecommercialinc.com](http://www.primecommercialinc.com)

DIXIE DIVINE  
CA BRE 00926251 & 01481181  
408.879.4001  
[ddivine@primecommercialinc.com](mailto:ddivine@primecommercialinc.com)

DOUG FERRARI  
CA BRE 01032363  
408.879.4002  
[dferrari@primecommercialinc.com](mailto:dferrari@primecommercialinc.com)

JEFF WYATT — WYATT & ASSOCIATES  
CO-LIST  
CA BRE 00775425  
408.832.6598

Prime Commercial, Inc. has obtained the information contained herein from sources we deem reliable. However, we have not verified its accuracy and make no guarantee, warranty or representation about it. It is subject to errors, modification, omission, change of price and/or terms, prior lease sale or financing, or withdraw without notice. It may include projections, opinions, or assumptions or estimated for example only, and they may represent current or future performance of the property. You and your tax and legal advisors should conduct your own due diligence of the property and transaction. The information provided in this brochure are estimates only, not representations, and are not intended to be relied upon for any purpose. All demographic information contained in this brochure is obtained from esri.



## PROPERTY INFORMATION

- NE Corner of Winchester Boulevard at Hwy 85
- Located across from Netflix & Roku Headquarters
- Access: Curb cuts on Winchester Boulevard
- APN #: 406-30-016
- Size: 0.53 Acres
- Zoning: C-1 Neighborhood
- Price: \$2,300,000.00
- Preliminary Plans for a 10,000 SF Medical Building

## CURRENT IMPROVEMENTS

- +/- 1,550 SF Residential House
- 3 Bedroom / 2 Bath

## TRAFFIC COUNTS

- Winchester Boulevard: 18,000 ADT
- Capri Drive: 912 ADT



1543 Lafayette Street, Suite C  
Santa Clara, 95050  
Office 408.879.4000  
[www.primecommercialinc.com](http://www.primecommercialinc.com)

DIXIE DIVINE  
CA BRE 00926251 & 01481181  
408.879.4001  
[ddivine@primecommercialinc.com](mailto:ddivine@primecommercialinc.com)

DOUG FERRARI  
CA BRE 01032363  
408.879.4002  
[dferrari@primecommercialinc.com](mailto:dferrari@primecommercialinc.com)

JEFF WYATT — WYATT & ASSOCIATES  
CO-LIST  
CA BRE 00775425  
408.832.6598

# PROPOSED TWO-STORY OFFICE BUILDING

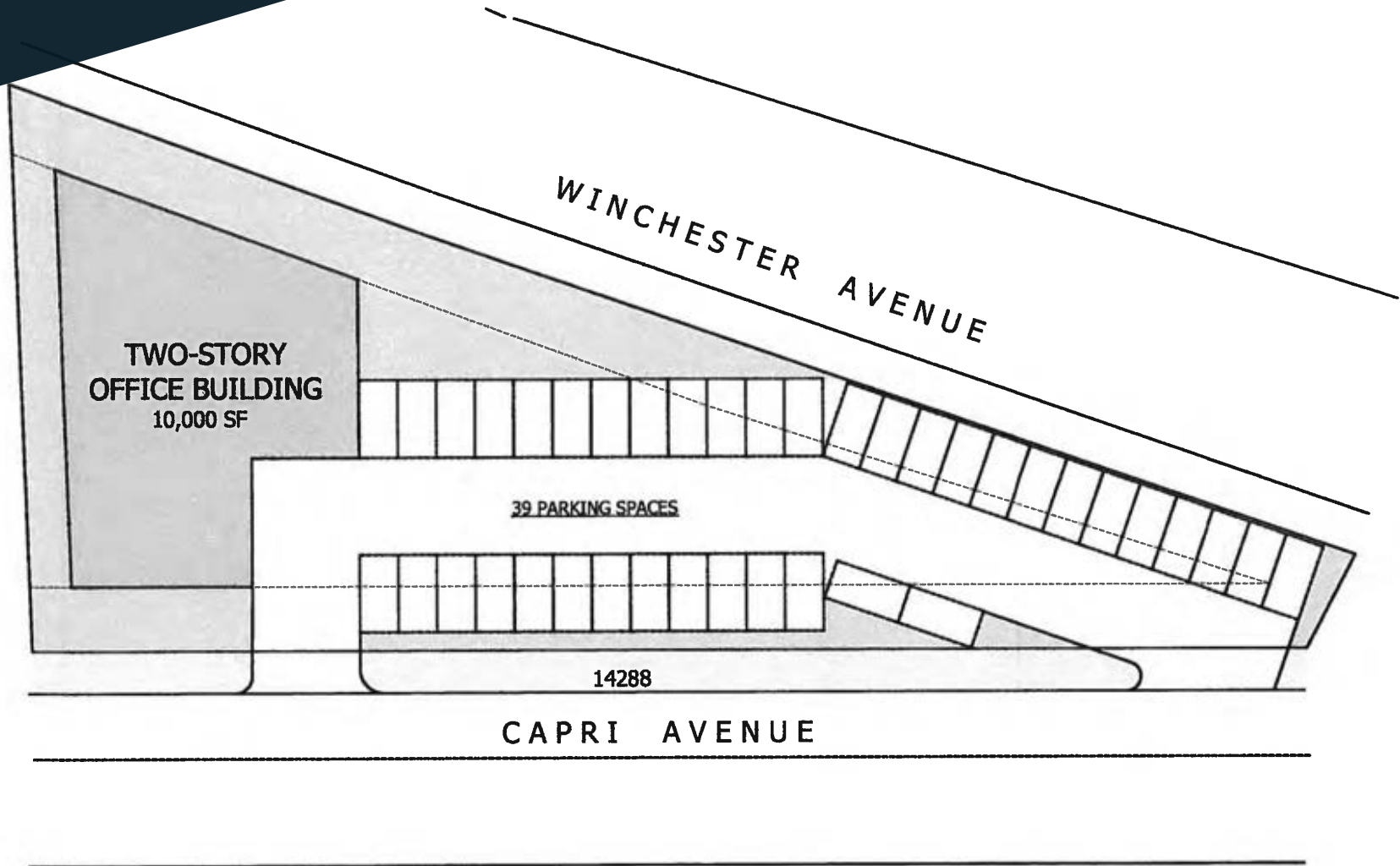

# PLAT MAP

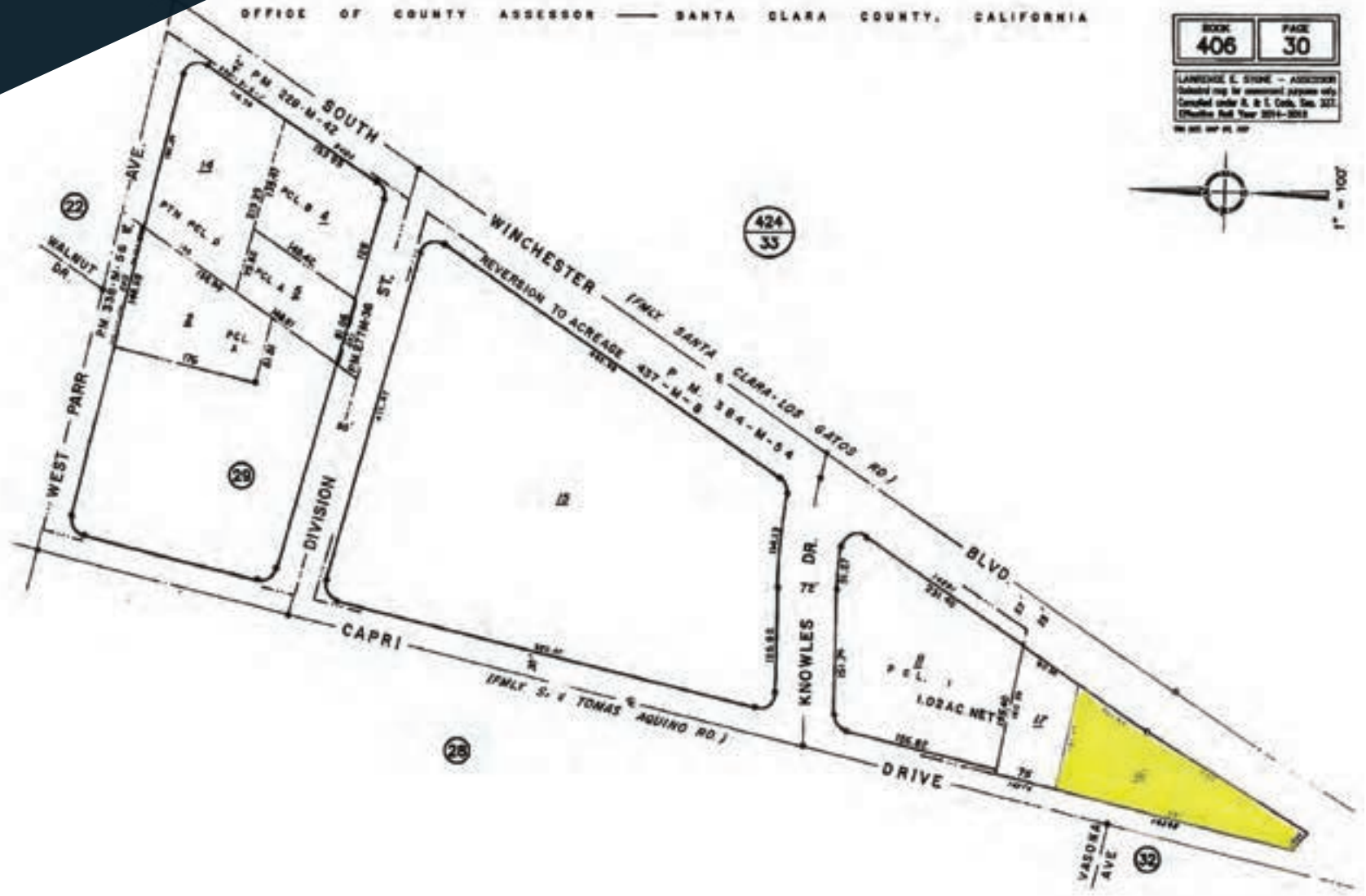

# AERIAL MAP



1543 Lafayette Street, Suite C

Santa Clara, 95050

Office 408.879.4000

[www.primecommercialinc.com](http://www.primecommercialinc.com)

DIXIE DIVINE

CA BRE 00926251 & 01481181

408.879.4001

[ddivine@primecommercialinc.com](mailto:ddivine@primecommercialinc.com)

DOUG FERRARI

CA BRE 01032363

408.879.4002

[dferrari@primecommercialinc.com](mailto:dferrari@primecommercialinc.com)

JEFF WYATT — WYATT & ASSOCIATES

CO-LIST

CA BRE 00775425

408.832.6598

 **PRIME COMMERCIAL**  
INCORPORATED

Prime Commercial, Inc. has obtained the information contained herein from sources we deem reliable. However, we have not verified its accuracy and make no guarantee, warranty or representation about it. It is subject to errors, modification, omission, change of price and/or terms, prior lease sale or financing, or withdraw without notice. It may include projections, opinions, or assumptions or estimated for example only, and they may represent current or future performance of the property. You and your tax and legal advisors should conduct your own due diligence of the property and transaction. The information provided in this brochure are estimates only, not representations, and are not intended to be relied upon for any purpose. All demographic information contained in this brochure is obtained from esri.

# DEMOGRAPHICS

## 1 Mile

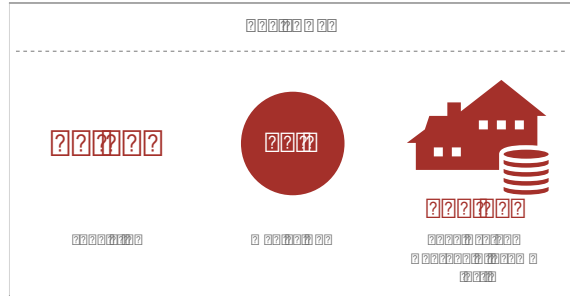

## 3 Miles

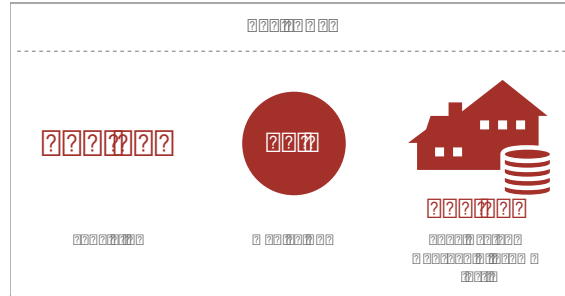

## 5 Miles

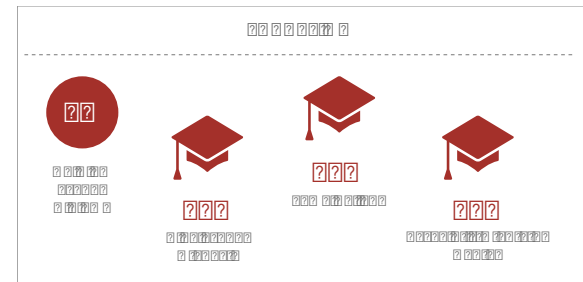
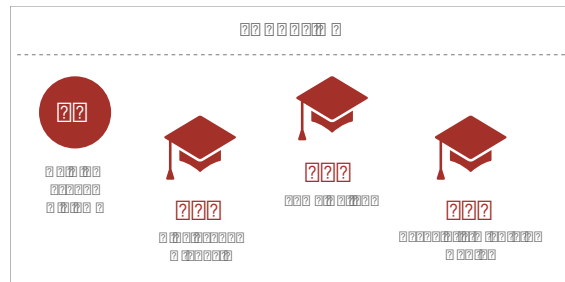
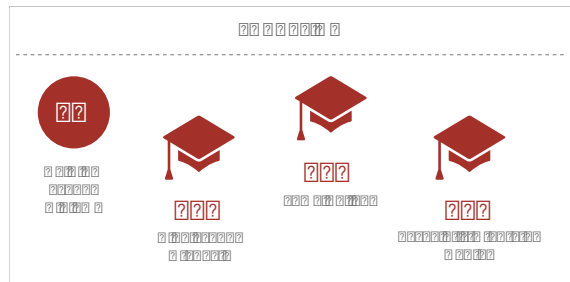
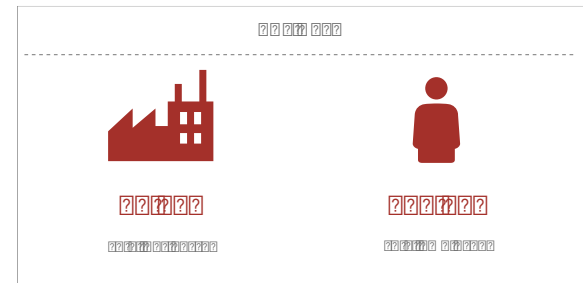
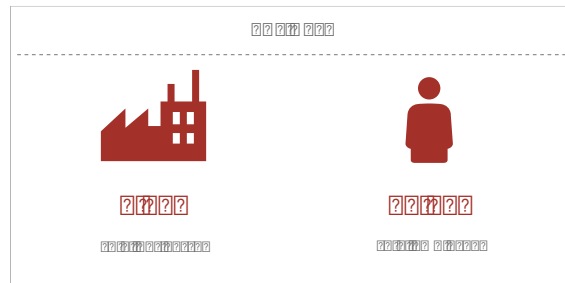
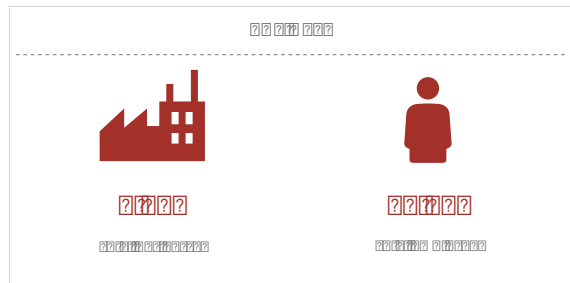
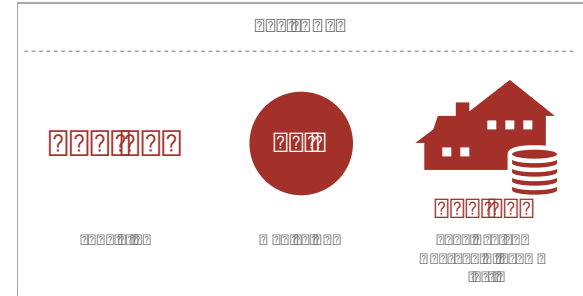

For more information, please contact

Dixie Divine

[ddivine@primecommercialinc.com](mailto:ddivine@primecommercialinc.com)

408-313-8900

LIC# 00926251

Doug Ferrari

[dferrari@primecommercialinc.com](mailto:dferrari@primecommercialinc.com)

408-718-0184

LIC# 01032363

Jeff Wyatt

Wyatt & Associates

Co-List

408-832-6598

LIC# 00775425



PRIME COMMERCIAL  
INCORPORATED