

# Bellomy Center

1975-1995 Bellomy St., Santa Clara, CA  
Retail Space for Lease



PROPOSED REMODEL - SUBJECT TO MODIFICATION

**PC** INC PRIME COMMERCIAL  
INCORPORATED

1543 Lafayette Street, Suite C  
Santa Clara, 95050  
Office 408.879.4000  
[www.primecommercialinc.com](http://www.primecommercialinc.com)

DIXIE DIVINE  
CA BRE 00926251 & 01481181  
408.879.4001  
[ddivine@primecommercialinc.com](mailto:ddivine@primecommercialinc.com)

DOUG FERRARI  
CA BRE 01032363  
408.879.4002  
[dferrari@primecommercialinc.com](mailto:dferrari@primecommercialinc.com)

DENISE LUPRETTE  
CA BRE 01735925  
408.879.4003  
[dlupretta@primecommercialinc.com](mailto:dlupretta@primecommercialinc.com)

Prime Commercial, Inc. has obtained the information contained herein from sources we deem reliable. However, we have not verified its accuracy and make no guarantee, warranty or representation about it. It is subject to errors, modification, omission, change of price and/or terms, prior lease sale or financing, or withdraw without notice. It may include projections, opinions, or assumptions or estimated for example only, and they may represent current or future performance of the property. You and your tax and legal advisors should conduct your own due diligence of the property and transaction. The information provided in this brochure are estimates only, not representations, and are not intended to be relied upon for any purpose. All demographic information contained in this brochure is obtained from esri.

# FEATURES & AMENITIES

Nestled between Bellomy Street and Saratoga Ave, Bellomy Center has six new retail spaces becoming available for lease. Priced at \$2.50 / SF + NNN.

## 600-1,385 SF Available

\*DIVISIBLE\*

- + Ground Floor Retail Space
- + Center Undergoing Complete Remodel
- + Desirable Neighborhood Serving Location
- + 2,000 SF patio being built along Bellomy St. for outdoor dining
- + Great End-Cap Unit
- + Close Proximity to Santa Clara University
- + Spaces Ranging from 600-1,385 SF



PROPOSED REMODEL - SUBJECT TO MODIFICATION



1543 Lafayette Street, Suite C  
Santa Clara, 95050  
Office 408.879.4000  
[www.primecommercialinc.com](http://www.primecommercialinc.com)

DIXIE DIVINE  
CA BRE 00926251 & 01481181  
408.879.4001  
[ddivine@primecommercialinc.com](mailto:ddivine@primecommercialinc.com)

DOUG FERRARI  
CA BRE 01032363  
408.879.4002  
[dferrari@primecommercialinc.com](mailto:dferrari@primecommercialinc.com)

DENISE LUPRETTE  
CA BRE 01735925  
408.879.4003  
[dlupretta@primecommercialinc.com](mailto:dlupretta@primecommercialinc.com)

Prime Commercial, Inc. has obtained the information contained herein from sources we deem reliable. However, we have not verified its accuracy and make no guarantee, warranty or representation about it. It is subject to errors, modification, omission, change of price and/or terms, prior lease sale or financing, or withdraw without notice. It may include projections, opinions, or assumptions or estimated for example only, and they may represent current or future performance of the property. You and your tax and legal advisors should conduct your own due diligence of the property and transaction. The information provided in this brochure are estimates only, not representations, and are not intended to be relied upon for any purpose. All demographic information contained in this brochure is obtained from esri.



## TRAFFIC COUNTS

9,810      12,287

BELLOMY STREET      SARATOGA AVE



## HOUSEHOLD INCOME

\$166,028      \$171,475      \$184,772

1 MILE      3 MILES      5 MILES



## POPULATION

29,139      231,192      645,538

1 MILE      3 MILES      5 MILES



1543 Lafayette Street, Suite C  
 Santa Clara, 95050  
 Office 408.879.4000  
[www.primecommercialinc.com](http://www.primecommercialinc.com)

DIXIE DIVINE  
 CA BRE 00926251 & 01481181  
 408.879.4001  
[ddivine@primecommercialinc.com](mailto:ddivine@primecommercialinc.com)

DOUG FERRARI  
 CA BRE 01032363  
 408.879.4002  
[dferrari@primecommercialinc.com](mailto:dferrari@primecommercialinc.com)

DENISE LUPRETТА  
 CA BRE 01735925  
 408.879.4003  
[dlupretta@primecommercialinc.com](mailto:dlupretta@primecommercialinc.com)

Prime Commercial, Inc. has obtained the information contained herein from sources we deem reliable. However, we have not verified its accuracy and make no guarantee, warranty or representation about it. It is subject to errors, modification, omission, change of price and/or terms, prior lease sale or financing, or withdraw without notice. It may include projections, opinions, or assumptions or estimated for example only, and they may represent current or future performance of the property. You and your tax and legal advisors should conduct your own due diligence of the property and transaction. The information provided in this brochure are estimates only, not representations, and are not intended to be relied upon for any purpose. All demographic information contained in this brochure is obtained from esri.

# FLOOR PLAN

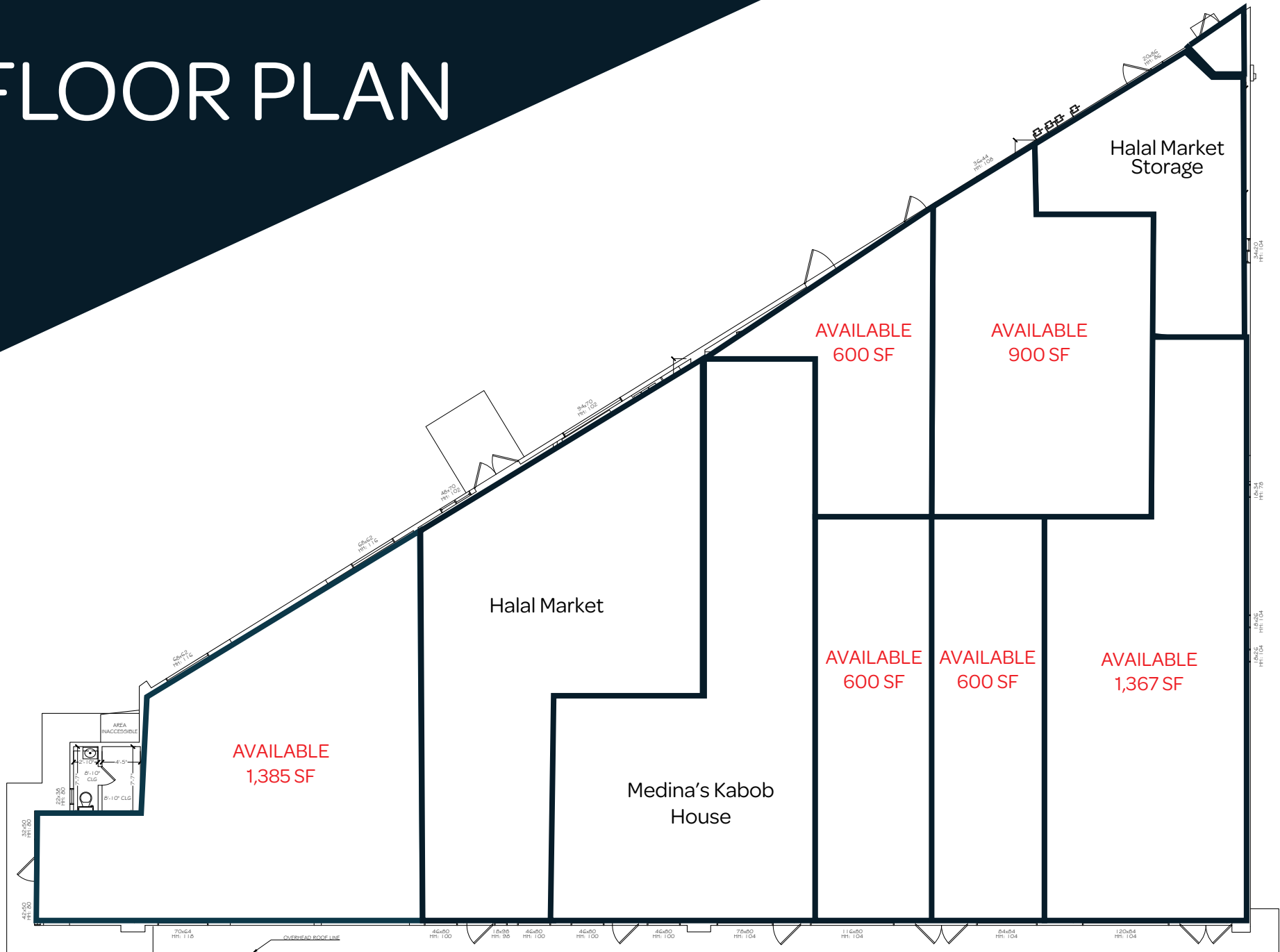

# SITE PARKING



1543 Lafayette Street, Suite C  
Santa Clara, 95050  
Office 408.879.4000  
[www.primecommercialinc.com](http://www.primecommercialinc.com)

DIXIE DIVINE  
CA BRE 00926251 & 01481181  
408.879.4001  
[ddivine@primecommercialinc.com](mailto:ddivine@primecommercialinc.com)

DOUG FERRARI  
CA BRE 01032363  
408.879.4002  
[dferrari@primecommercialinc.com](mailto:dferrari@primecommercialinc.com)

# AERIAL MAP

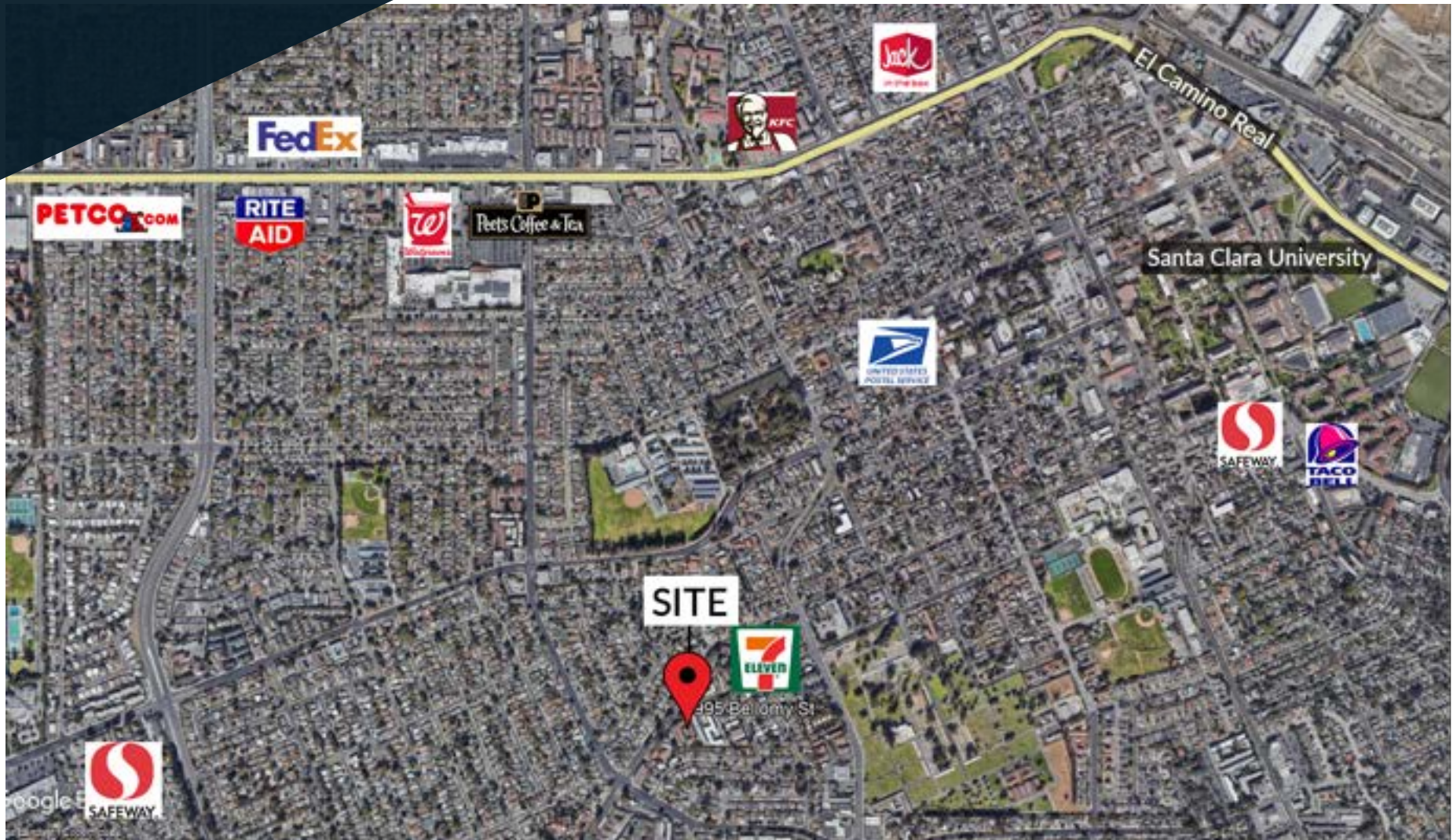

**PRIME COMMERCIAL**  
INCORPORATED

1543 Lafayette Street, Suite C

Santa Clara, 95050

Office 408.879.4000

[www.primecommercialinc.com](http://www.primecommercialinc.com)

DIXIE DIVINE

CA BRE 00926251 & 01481181

408.879.4001

[ddivine@primecommercialinc.com](mailto:ddivine@primecommercialinc.com)

DOUG FERRARI

CA BRE 01032363

408.879.4002

[dferrari@primecommercialinc.com](mailto:dferrari@primecommercialinc.com)

DENISE LUPRETTA

CA BRE 01735925

408.879.4003

[dlupretta@primecommercialinc.com](mailto:dlupretta@primecommercialinc.com)

For more information, please contact

Dixie Divine

ddivine@primecommercialinc.com  
408-313-8900  
LIC# 00926251

Doug Ferrari

dferrari@primecommercialinc.com  
408-718-0184  
LIC# 01032363

Denise Lupretta

dlupretta@primecommercialinc.com  
408-314-3240  
LIC# 01735925



PRIME COMMERCIAL  
INCORPORATED