

# CAHALAN SQUARE

5750 SANTA TERESA BLVD., SAN JOSE, CA

Retail Space Available for Lease



DIXIE DIVINE | [ddivine@primecommercialinc.com](mailto:ddivine@primecommercialinc.com) | 408-313-8900  
Lic. 00926251 & 01481181

DOUG FERRRI | [dferrari@primecommercialinc.com](mailto:dferrari@primecommercialinc.com) | 408-879-4002  
Lic. 01032363

 PRIME COMMERCIAL  
INCORPORATED

1543 Lafayette St, Suite C, Santa Clara, CA 95050  
OFFICE: (408) 879-4000  
[www.primecommercialinc.com](http://www.primecommercialinc.com)





# Property Highlights

## FEATURES

- Attractive, newly constructed retail strip center in desirable Blossom Valley District of South San Jose
- Excellent demographics
- Outdoor dining areas available
- Ample parking ratio
- \$2.75 - 3.00 / SF + NNN \$0.90

## DEMOGRAPHICS

	1 MILE	3 MILES	5 MILES
Population	35,697	158,281	321,618
Avg. HH Income	\$148,752	\$174,765	\$171,836

## TRAFFIC COUNTS

- Santa Teresa Blvd: 24,000 ADT
- Cahalan Ave: 22,000 ADT

# Floor Plan

## AVAILABLE UNITS

UNIT 15: 1,420 SF  
 UNIT 25: 1,805 SF

UNIT 65: 817 SF  
 UNIT 75: 2,067 SF  
 UNIT 85: 949 SF  
 UNIT 95: 995 SF

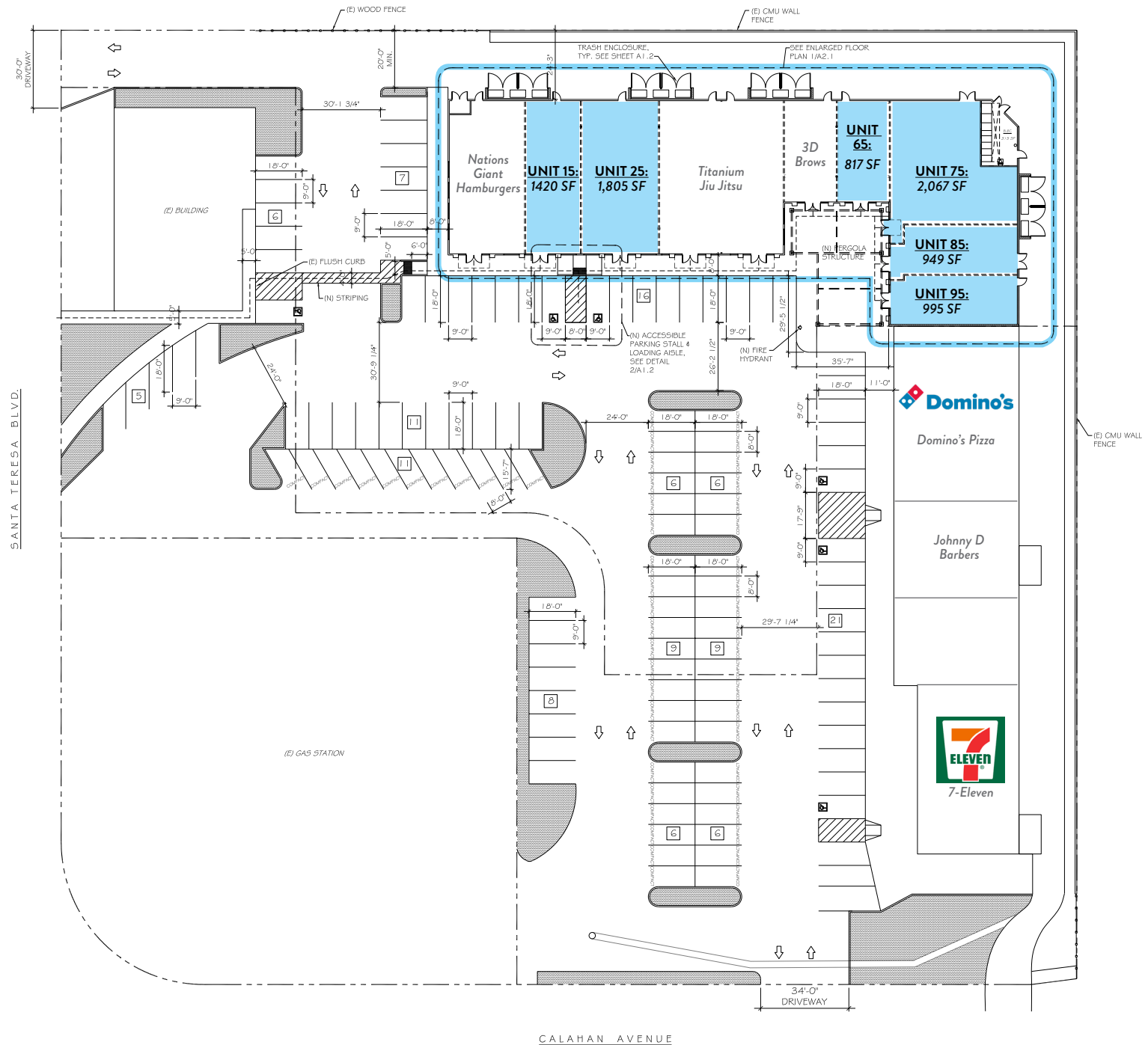





# Aerial Map

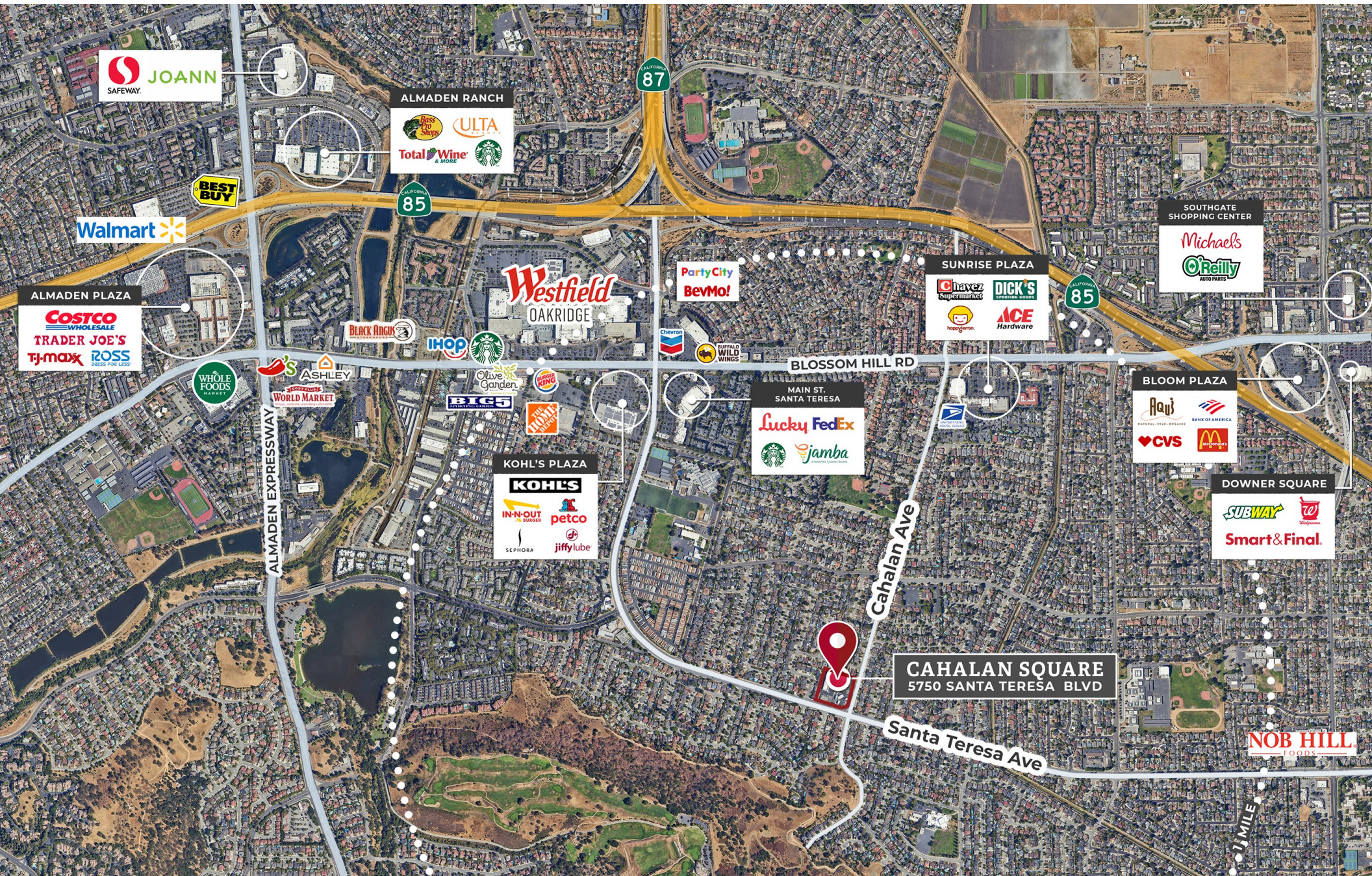



## For More Information, Please Contact

Dixie Divine

[ddivine@primecommercialinc.com](mailto:ddivine@primecommercialinc.com)

408-313-8900

LIC# 00926251

Doug Ferrari

[dferrari@primecommercialinc.com](mailto:dferrari@primecommercialinc.com)

408-218-0184

LIC# 01032363

