



# NORTH PARK VILLAGE

39 Rio Robles E. | San José, CA 95134

**1,745 SF** Gross Leasable Area

Apartment Units: 2,762

- Easy access from the San Tomas/Montague Expressway
- Located within North San José Innovation Triangle; home to the world's most recognized companies including Broadcom, Cisco, Intel and Oracle
- North Park is a residential community of 2,750+ luxury apartment homes within one mile of additional Irvine Company apartment developments: Crescent Village and River View
- All residential communities combined offer 6,250+ luxury apartments in the immediate trade area providing an ample customer base with access for direct marketing
- Walking distance to the River Oaks Light Rail VTA Station at River Oaks Parkway and North First Street

## KEY TENANTS

**Qargo Coffee**

The Market at North Park

## AVERAGE DAILY TRAFFIC COUNTS

**25,000**

N. First St. at Baypointe Dr.

**14,000**

Zanker Road at Estancia Dr.

**39,000**

Total

## DEMOGRAPHICS

3 MILE RADIUS

**773**

POPULATION

**217,056**

DAYTIME POPULATION

**\$194,151**

AVERAGE HOUSEHOLD INCOME

**36**

AVERAGE AGE

## APARTMENT RESIDENT PROFILE

**\$165,628**

AVERAGE HOUSEHOLD INCOME

**33**

AVERAGE AGE

For leasing information, call Prime Commercial, Inc at 408.879.4000

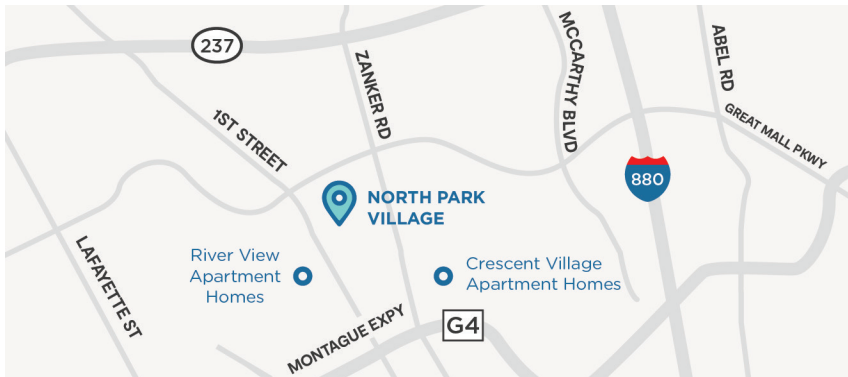

# NORTH PARK VILLAGE

San José, California

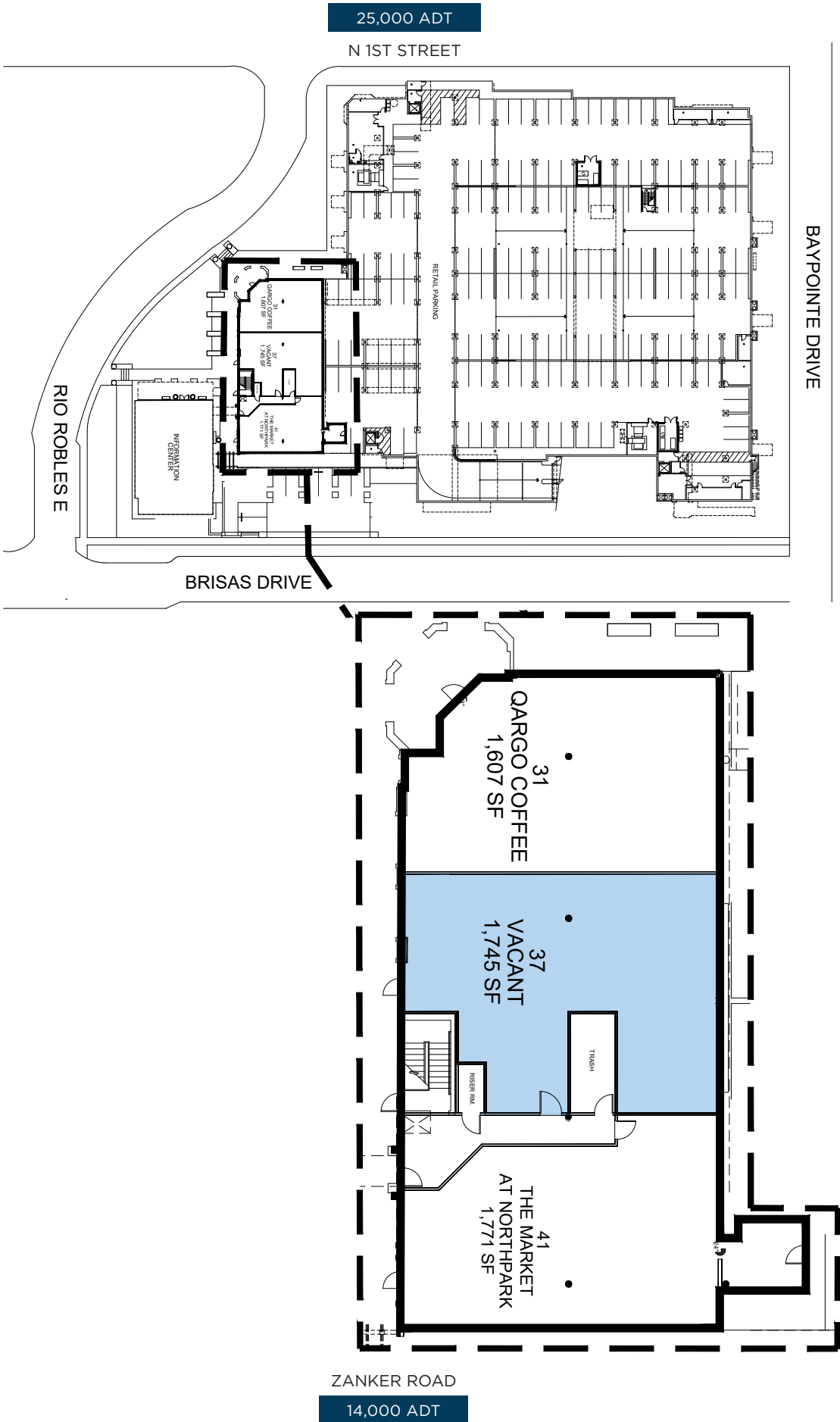

**PRIMECOMMERCIALINC.COM / FOR LEASING INFORMATION, CALL 408.879.4000**

© 2024 Irvine Management Company. All Rights Reserved. Sources: 2023 Esri, 2022 Kalibrate Technologies. The information contained herein has been obtained from sources we deem reliable. While we have no reason to doubt its accuracy, we do not guarantee it. This is a schematic plan intended only to show the general layout of the Shopping Center and the approximate location of the Premises. Landlord, at any time, may change the shape, size, location, number and extent of the improvements shown herein, as well as any additional improvements. Landlord may eliminate, add or relocate any improvements to any portion of the Shopping Center, including, without limitation, buildings, parking areas or structures, roadways, curb cuts, temporary or permanent kiosks, displays or stands, and may add land to and/or withdraw land from the Shopping Center. Plan not to scale.

All properties are offered for lease through Irvine Management Company, a licensed real estate broker DRE LIC. #02041810 and in contracted partnership with Prime Commercial, Incorporated, a licensed real estate broker DRE LIC. #01481181.